

产品规格说明书

SPECIFICATION FOR APPROVAL

Parameter	Spec
靶面尺寸	2/3"
放大率	2.0x
接口	C 接口
NA	0.074
工作距离	110mm
物方分辨率	4.5um
畸变	<0.1 %
工作波长	450-650nm
景深	0.27mm

Lens Shape

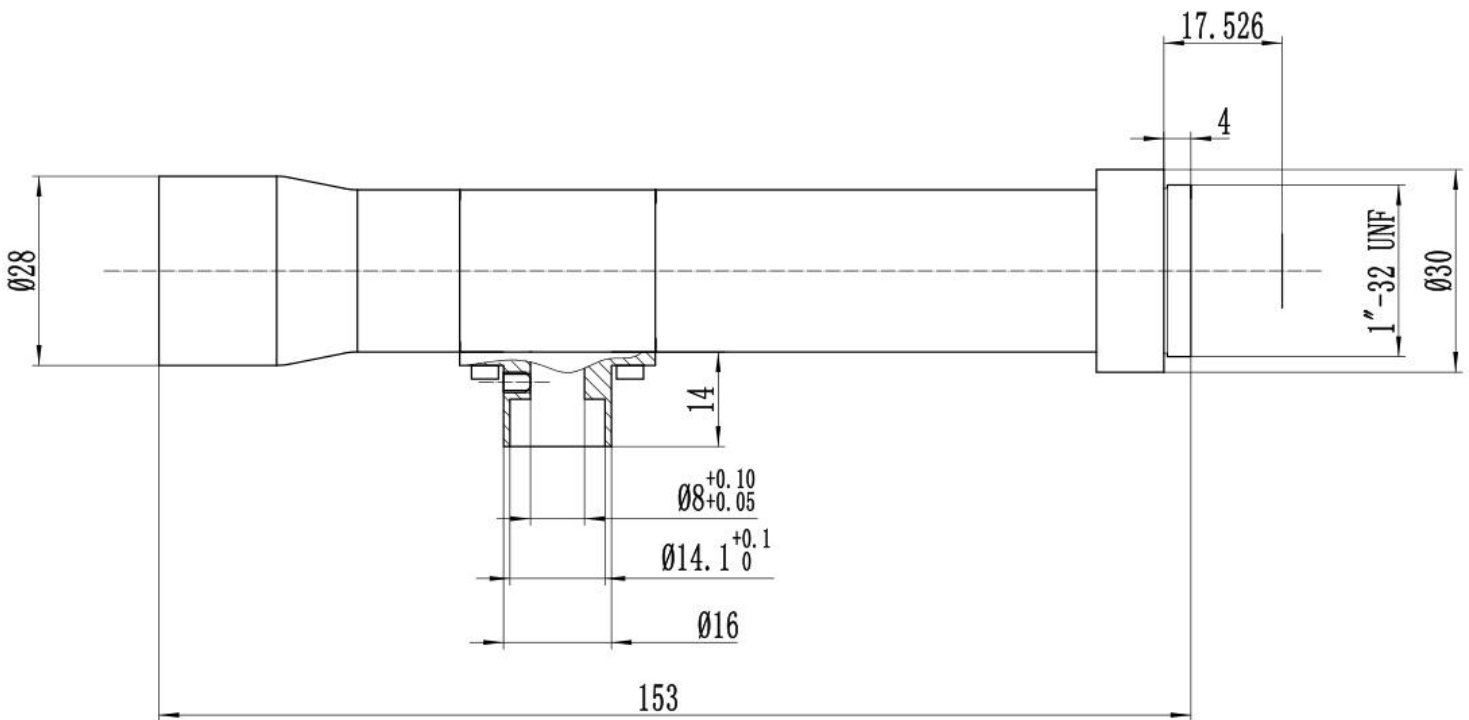

MTF

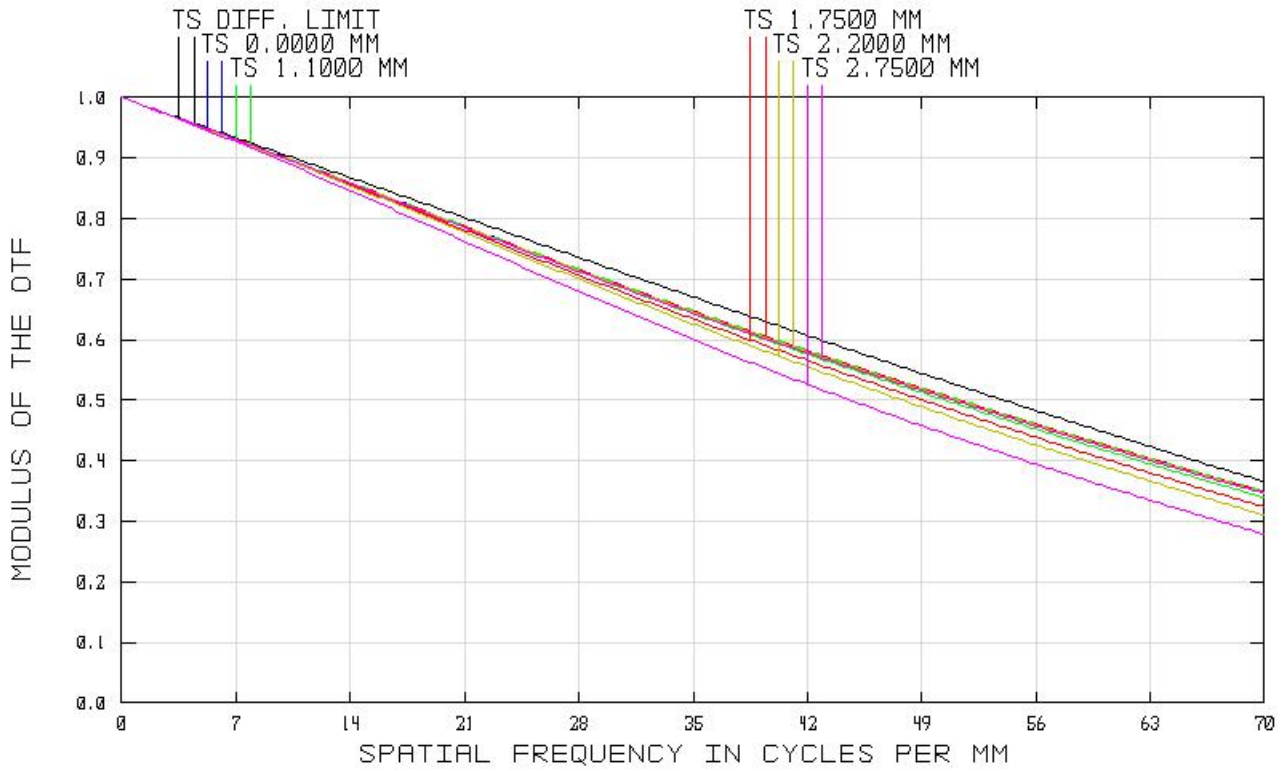

星点

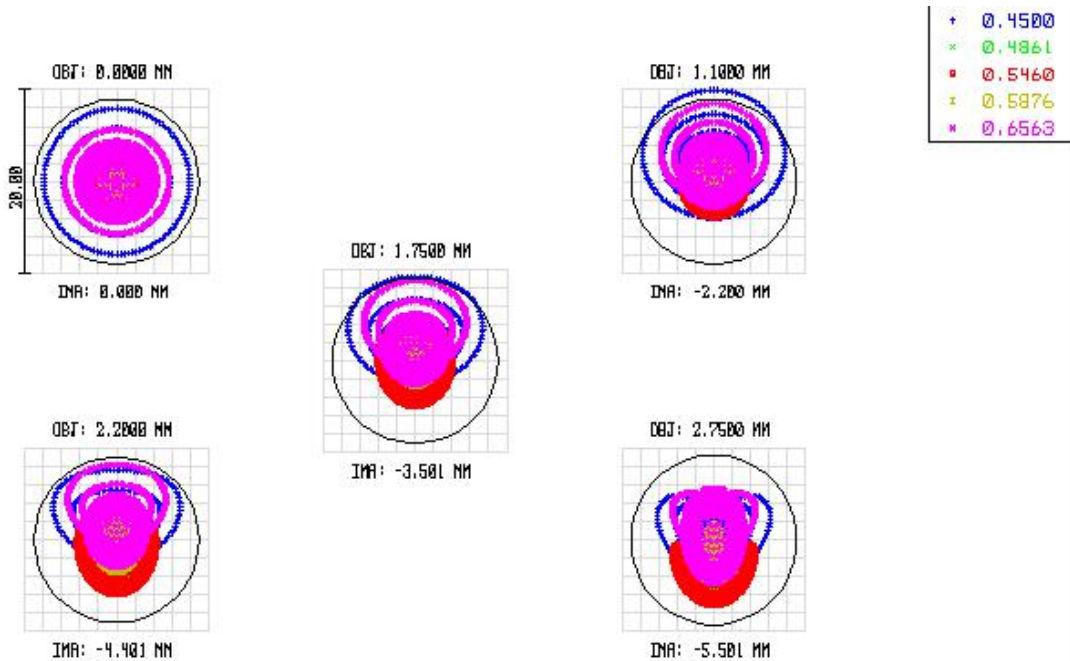

SURFACE: IMA

SPOT DIAGRAM

TUE APR 23 2019 UNITS ARE μm . AIRY RADIUS : 9.003 μm

FIELD :	1	2	3	4	5
RMS RADIUS :	2.625	2.737	2.815	2.849	3.078
GEO RADIUS :	7.938	9.951	9.247	8.475	7.132

QUEDING20180719.ZMX

畸变

DISTORTION

+Y

